

**Rauhala School.** Opened about 1910. Closed 1936. Sold in 1940.  
T55N 34W SE ¼ of SE ¼ in Section 19, SE corner.  
Near Anderson. On Herman Junttonen property.

**Barb Koski desires a photo of the school. Contact webmaster if you have one.**

**Where was it located?**

The 1923 Plat Map Don Heikkila gave Barb has it marked on the Junttonen Property on corner of Section 19, 20,29 and Section 30, which today is the North West corner of Niemi Road and Rauhala Road. The four corner neighbors then were Anderson (SW), Raisanen (SE), and Zurcher (NE). This is a section North from Coles Creek Roa

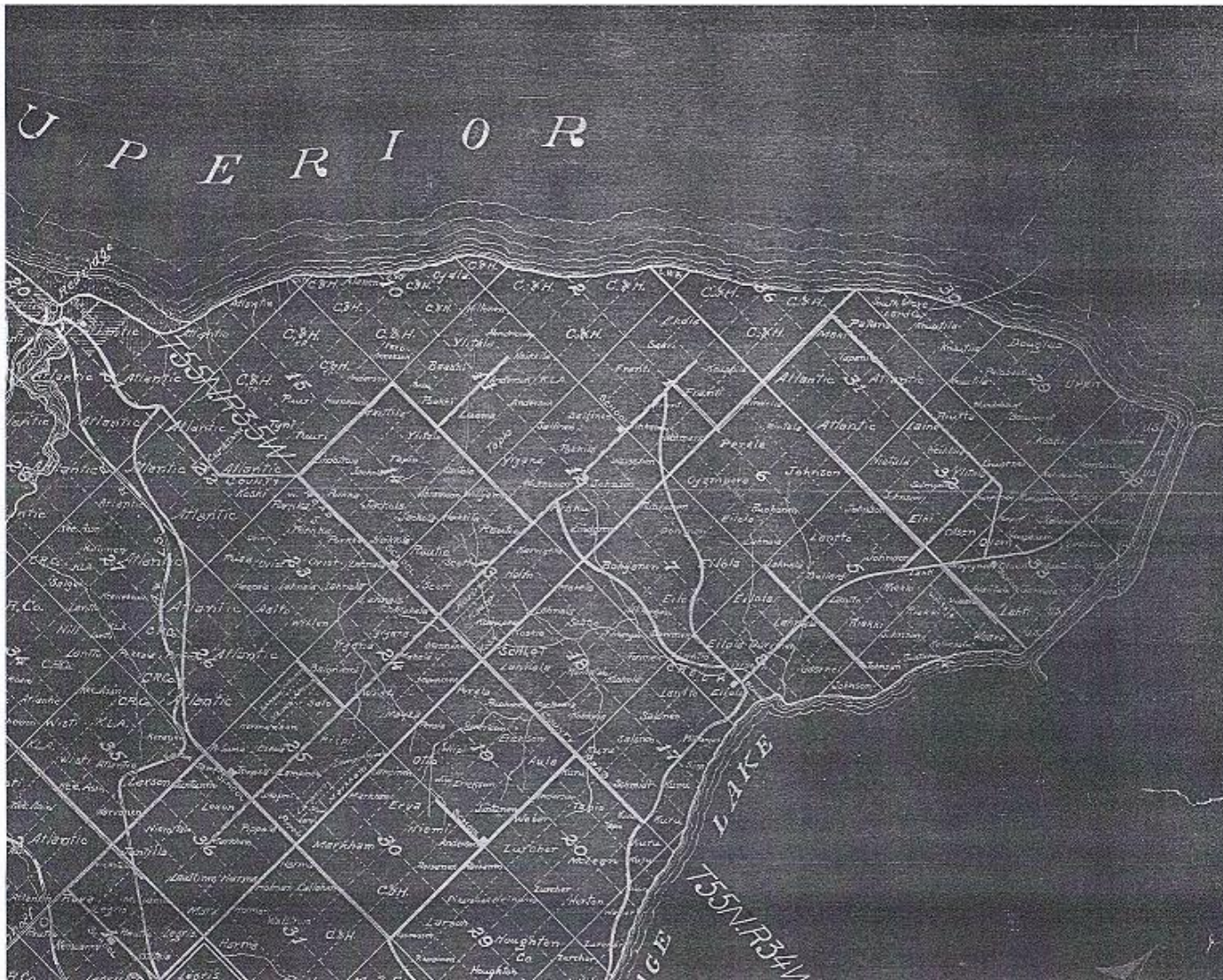

Mel Anderson attended the school and recalls walking south down the Rauhala Road he lived on near Liminga Road and it being on the right side (west). He said it moved a few times.. He heard that it was on the section line west of Zuchers, behind the Poor Farm. Then it moved to where he attended. After the school closed in 1936 it was moved to the

Zenner property and lastly to Joe Ovist's home on the Coles Creek Road.

Mel Anderson shares: I went to Rauhala School to fourth grade (1931-1936). I lived just down the road (North) so I walked. My first teacher was Helen Erickson. 2<sup>nd</sup> teacher I have forgotten, the third teacher was Miss Jaakola.

The school closed in 1936.

I went fifth and sixth to Liminga, seven through tenth at Redridge, then eleven and twelve to Houghton.

A homemade bus of Bill Ruohonen's was the first bus.

Mrs. Pusa was teacher at Liminga.

Alvar Eilola, Bill Brinkman and Tarmo Maatala were my Redridge teachers.

The school was moved by skidding to become a family home for Joe Ovist family (Earl Lampinen's nephew) on Coles Creek Road by Rauhala Road.

Neighbors in 1923 (Plat Map) were:

In Section 20: Zurcher, J. Kuru, Tapio, Anderson, Weber (In 1959 for that same section the neighbors are: Ray Johnson, Francis Weber, Wm. Ruohonen (he had a store here where the Schmidt's corner store was and fire hall is) , HE Knight, Arvid Kaurilla, Alf. Korpela, HP Anderson, Mrs. Grover Lanctot)

Section 29 in 1923 were: (On 1959 plat map for same section was: EW Raisanen, Walfred Riipi, Rudy Larson, W Lunsted, Houghton Co. Infirmary and Edw. Heinonen.)

Section 30 in 1923 were: Anderson, Niemi, Erva, Lampinen, Markham, C and H. (On 1959 plat map were: HP Anderson, EW Raisanen, Copper Range, John Markham, Chas Markham, Art Lampinen, Walfren Niemi, Wallace Niemi)

Section 19 in 1923 were: Junttonen, Aula, Erickson, Ruohonen Perala, Ottio. (On 1959 plat map were: Junttonen Bros. {1923 map has school on their property} Victor Aula, Carl Erickson, Char. Ruohonen, John Porkka, Earnest Riipi, Walt Erva).

**School Board minutes** of 1940 - Feb.14 – Verified the sale of Heinola and Junttonen (Rauhala) Schools which was voted on Feb. 10<sup>th</sup>. Posted bids up to March 9. Highest bidders received sale. Heinola School Art Lantto for \$142.62 (others listed in minutes) and Junttonen (Rauhala) to Selma Lantto for \$82.58.

WGT 11/1-8/15

## Pupils pose for a pretty picture

MTU ARCHIVES VERTICAL FILE



This photo was taken at the Rauhala School in Liminga around 1915 to 1917. The photo was submitted by family members of Eleanor (Junttonen) Alanen, the tallest girl pictured on the left. Her family is asking residents to help identify any of the other children who are pictured. Residents who may be able to identify anyone else in the picture are asked to call Violet Moehrke at 296-0674 or write 1211 Front St., Lake Linden, MI. 49945.

School - Stanton J. J.  
Rauhala School

Researched by Barb Koski Osma Plat Road Houghton MI 49931 in 2009.  
Submitted 2011. Contact Webmaster with other information.

---

<sup>1</sup> MTU archives vertical file